

Flygt 3126

Table of Contents

1 Introduction.....	2
1.1 Specially approved products.....	2
2 Product Description.....	3
2.1 The data plate.....	3
2.2 Approvals.....	4
2.3 Product denomination.....	5
3 Spare Parts.....	7
3.1 Exploded view.....	7
3.2 List of parts.....	17

1 Introduction

Purpose of this manual

The purpose of this manual is to provide necessary information on spare parts and accessories order.

Disclaimer

Always use genuine Flygt parts. The use of other spare parts or accessories can invalidate any claims for warranty or compensation. Xylem does not take any responsibility for damages that are caused by the use of non-original parts. For more information, contact your local sales and service representative.

Data for ordering spare parts

The following information is needed for spare part orders:

- Serial number of the product
- Part number
- Quantity of bulk material, see * in tables

1.1 Specially approved products

Qualification of personnel

Only Xylem or Xylem-authorized service personnel may undertake repair work on specially approved products.

Dimensional accuracy inspection

Spare parts marked with (Ex) after the part number are subject to dimensional accuracy inspection when used in specially approved products.

2 Product Description

2.1 The data plate

The data plate is a metal label that is located on the main body of the products. The data plate lists key product specifications. Specially approved products also have an approval plate.

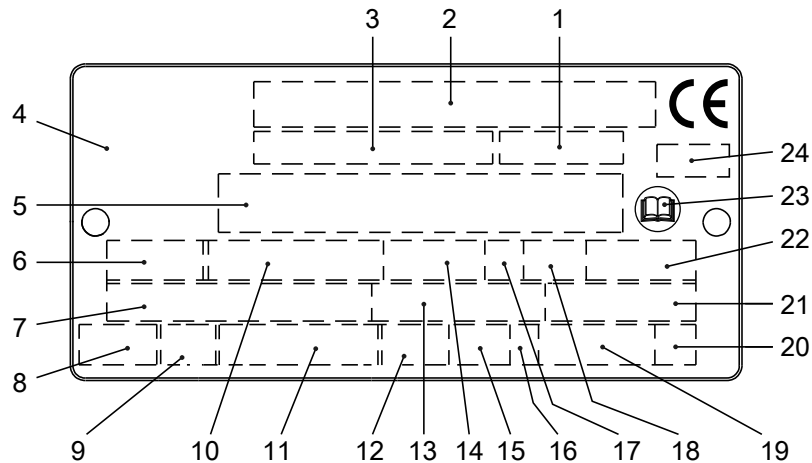

1. Curve code or Propeller code
2. Serial number
3. Product number
4. Country of origin
5. Additional information
6. Phase; type of current; frequency
7. Rated voltage
8. Thermal protection
9. Thermal class
10. Rated shaft power
11. International standard
12. Degree of protection
13. Rated current
14. Rated speed
15. Maximum submergence
16. Direction of rotation: L=left, R=right
17. Duty class
18. Duty factor
19. Product weight
20. Locked rotor code letter
21. Power factor
22. Maximum ambient temperature
23. Read installation manual
24. Notified body, only for EN-approved Ex products

Figure 1: The data plate

WIS006257A

2.2 Approvals

Product approvals for hazardous locations

Pump	Approval
3126.290	European Norm (EN) <ul style="list-style-type: none"> • ATEX Directive • EN 60079-0:2009, EN 60079-1:2007, EN 13463-1:2009, EN 13463-5:2011 • Ex II 2 G c Ex d IIB T4 Gb
	EN approval for cable entry: <ul style="list-style-type: none"> • Certificate number: INERIS 02ATEX9008 U • Ex II 2 G Ex d IIC Gb or I M2 Ex d I Mb
	IEC <ul style="list-style-type: none"> • IECEx scheme • IEC 60079-0, IEC 60079-1 • Ex d IIB T4
	FM (FM Approvals) <ul style="list-style-type: none"> • Explosion proof for use in Class I, Div. 1, Group C and D • Dust ignition proof for use in Class II, Div. 1, Group E, F and G • Suitable for use in Class III, Div. 1, Hazardous Locations
	CSA Ex <ul style="list-style-type: none"> • Explosion proof for use in Class I, Div. 1, Group C and D

EN approval plate

This illustration describes the EN approval plate and the information that is contained in its fields.

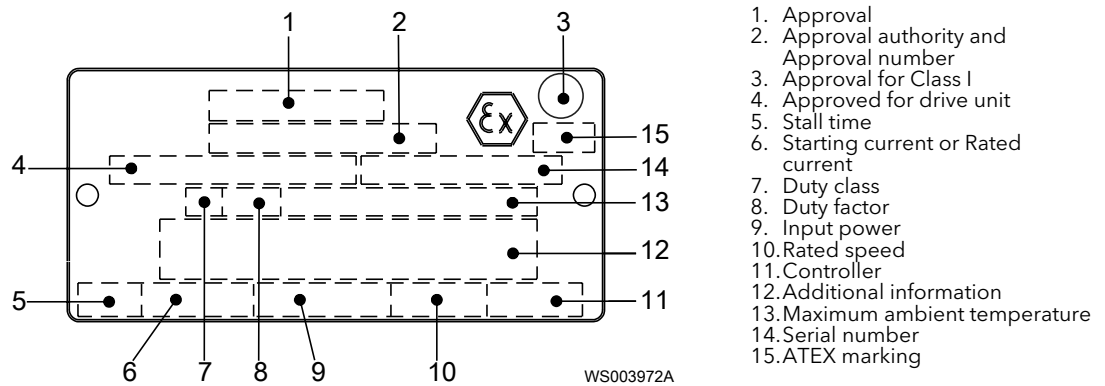

IEC approval plate

This illustration describes the IEC approval plate and the information that is contained in its fields.

International Norm; not for EU member countries.

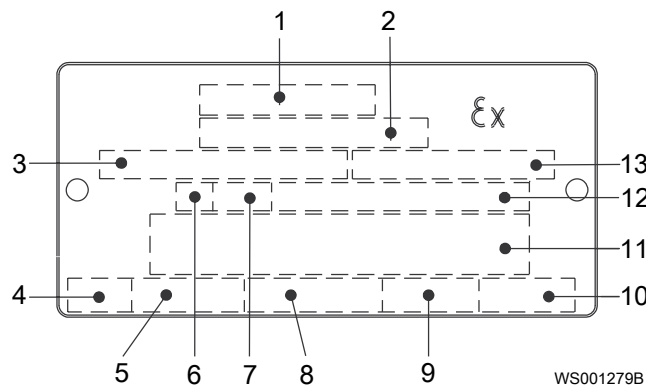

1. Approval
2. Approval authority and Approval number
3. Approved for drive unit
4. Stall time
5. Starting current or Rated current
6. Duty class
7. Duty factor
8. Input power
9. Rated speed
10. Controller
11. Additional information
12. Maximum ambient temperature
13. Serial number

FM approval plate

This illustration describes the FM approval plate and the information that is contained in its fields.

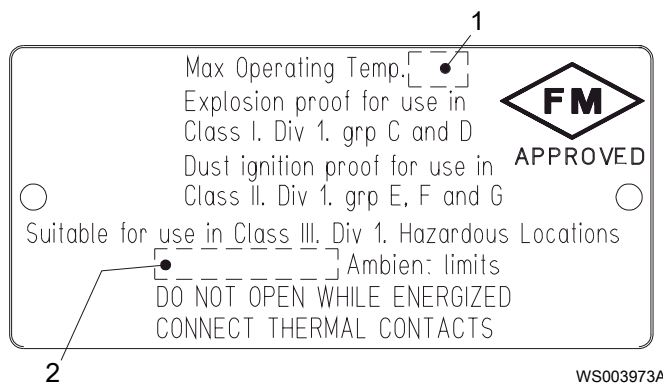

1. Temperature class
2. Maximum ambient temperature

CSA approval plate

This illustration describes the CSA approval plate and the information that is contained in its fields.

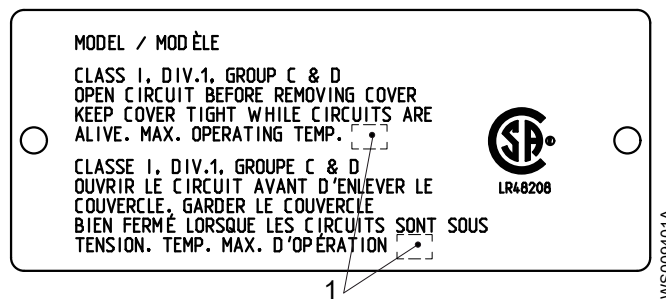

1. Temperature class

2.3 Product denomination

Reading instruction

In this section, code characters are illustrated accordingly:

X = letter

Y = digit

The different types of codes are marked up with a, b and c. Code parameters are marked up with numbers.

Codes and parameters

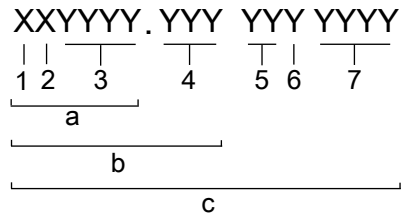

WS006265B

Type of Callout	Number	Indication
Type of code	a	Sales denomination
	b	Product code
	c	Serial number
Parameter	1	Hydraulic end
	2	Type of installation
	3	Sales code
	4	Version
	5	Production year
	6	Production cycle
	7	Running number

3 Spare Parts

3.1 Exploded view

Drive unit

3126.290

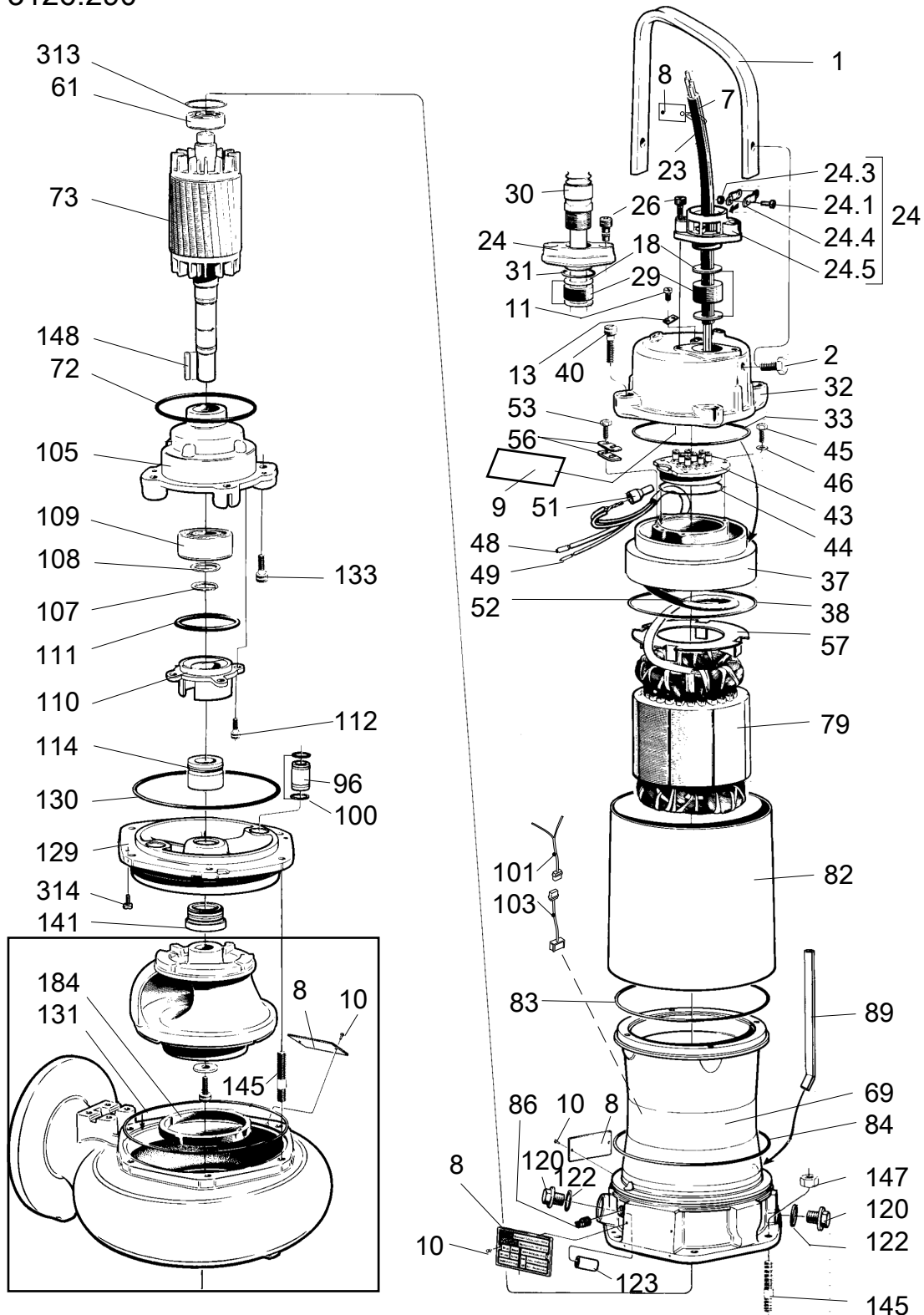

31153

C_ MT, curve: 430, 432

C_ 3126 MT

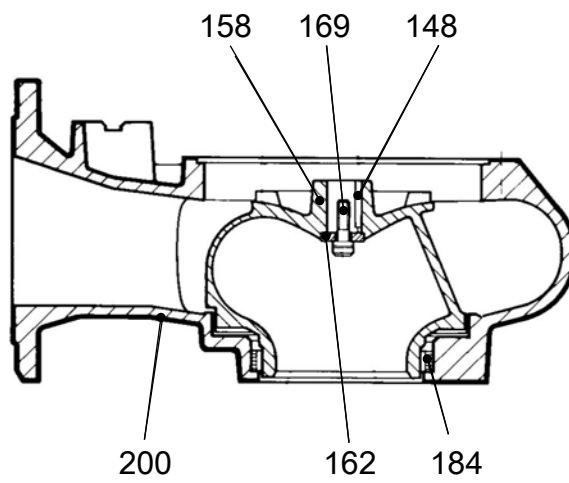

31151

C_HT, curve: 250, 252

C_ 3126 HT

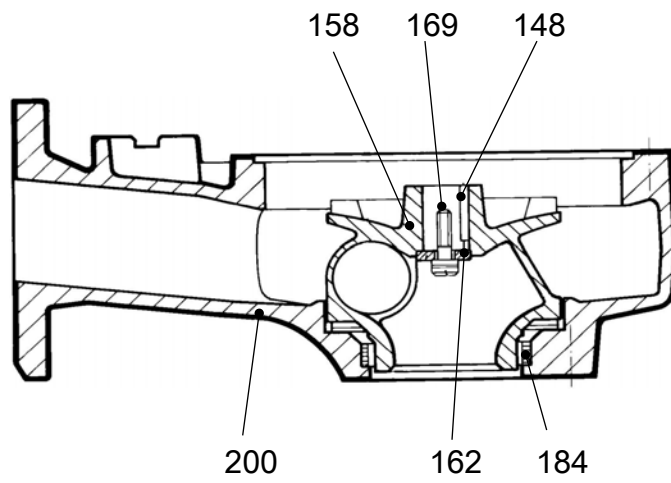

31150

C_HT, curve: 461, 462, 467

C_3126 HT

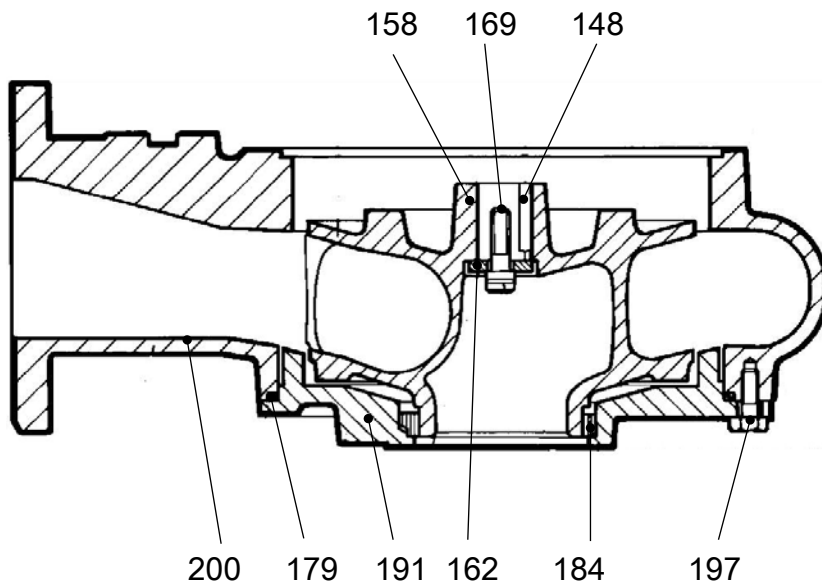

31149

D_ MT, curve: 475 - 479

D_ 3126 MT

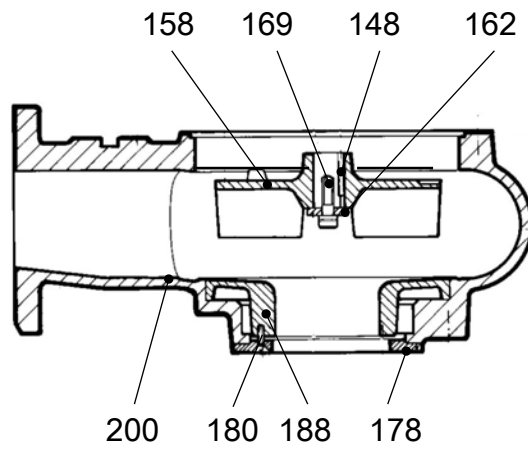

31148

D_HT, curve: 287

D_3126 HT

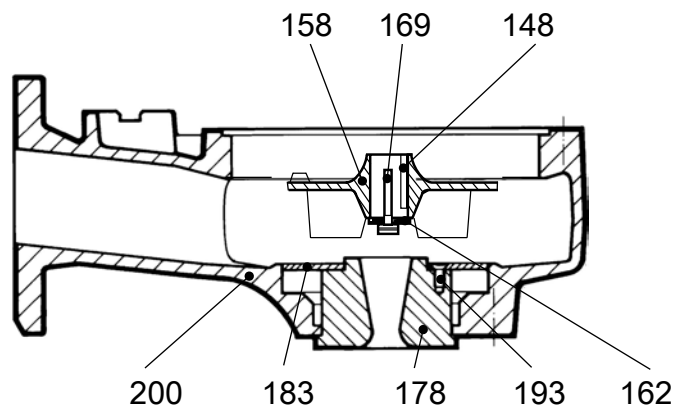

31147

CP/DP

CP/DP 3126

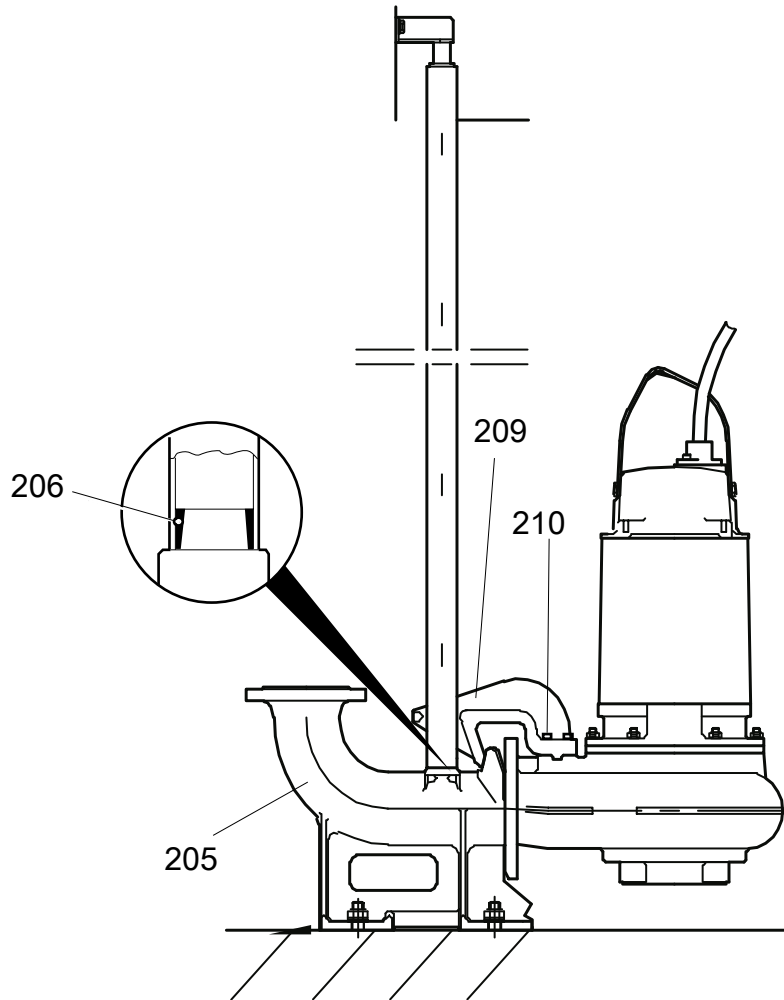

31154B

CS/DS

CS/DS 3126

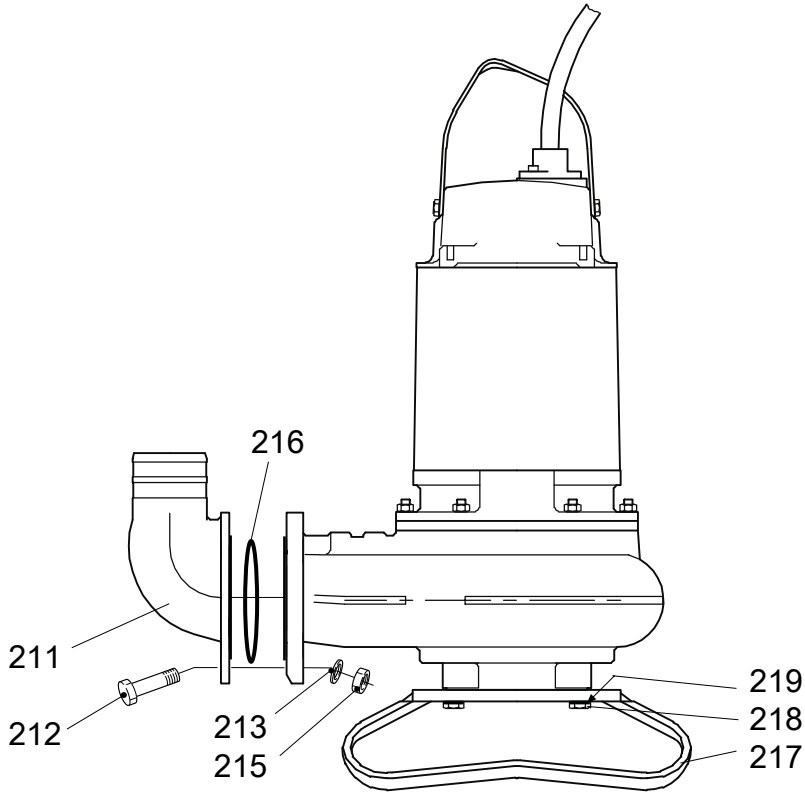

31155B

CT

CT 3126

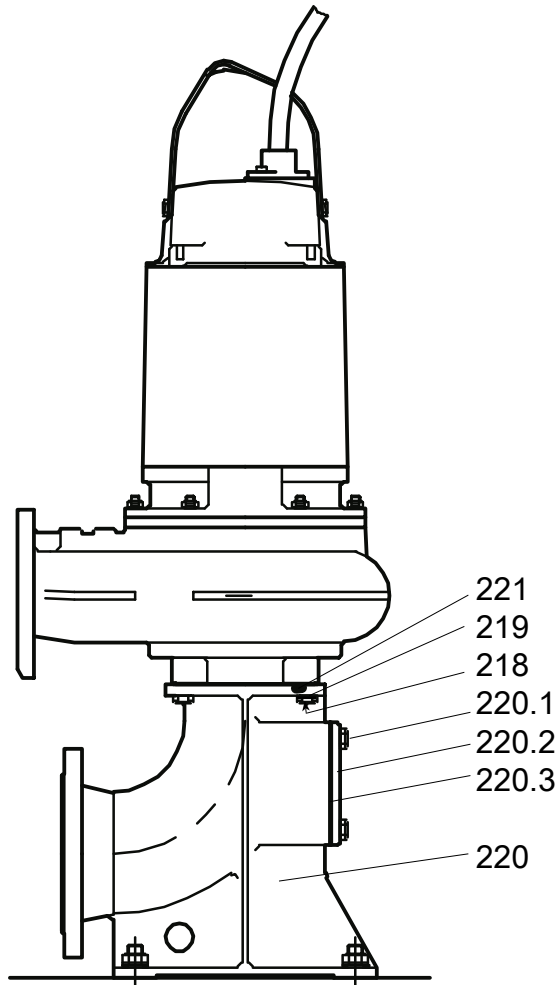

31156B

CZ

CZ 3126

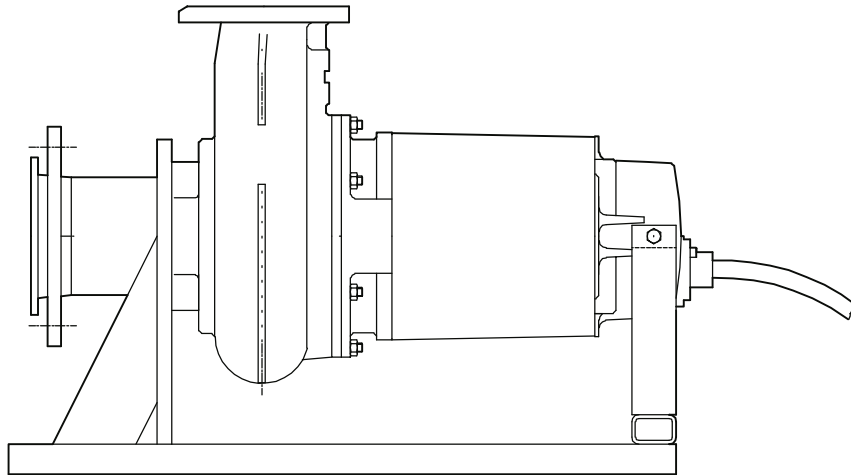

31157B

3.2 List of parts

Pos. No	Part. No	Type	Denomination	Qty/Version
				290
1	308 86 02		Lifting handle	1
2	81 49 02		Hexagon head screw M12X20-A4-70	2
7	83 45 59		Cable tie 200X2.4 PA 6/6 -55+105	1
8	630 68 00		Data plate USE 6306801 AS SPARE PART	2
8	640 76 00		Caution plate	1
8	630 69 00		Certificate plate EN	2
8	630 69 01	(Ex)	Certificate plate IECEX	2
8	630 70 00		Certificate plate FM	2
9	698 86 00		Connection plate	1
9	698 77 00		Connection plate	1
9	550 22 00		Connection plate (FLS)	1
10	82 21 73		Drive screw 4X5-A4	12
11	249 88 04		Earthing screw	2
13	279 29 02		Earthing plate	1
23	94 20 82		Motor cable subcab 7G2,5+2X1,5	*
23	94 21 08		Motor cable SUBCAB 8AWG/3-2-1-GC	*
23	94 21 09		Motor cable SUBCAB 6AWG/3-2-1-GC	*
23	94 21 06		Motor cable SUBCAB 10AWG/3-2-1-GC	*
23	94 20 59		Motor cable subcab 4G2,5+2X1,5	*
24	642 17 03	(Ex)	Entrance flange	1
24	597 87 00	(Ex)	Entrance flange	1
24	597 87 01	(Ex)	Entrance flange ISO G1 1/4	1
26	83 03 47		Hex.socket hd screw M12X35-A4-70	2
26,4	82 42 72		Plain washer (32)-34 MM	4
26,5	84 19 45		Seal sleeve (29)-32 MM	2
26,6	597 98 02		Sleeve	1
30	83 03 47		Hex.socket hd screw M12X35-A4-70	2
31	82 81 03		O-ring 49.5X3 FPM	1
32	429 01 04	(Ex)	Entrance cover	1
33	82 75 24		O-ring 194.3X5.7 FPM	1
37	428 11 02	(Ex)	Bearing housing	1
38	82 71 64		O-ring 215,99X3,53 FPM	1
40	83 03 47		Hex.socket hd screw M12X35-A4-70	4
43	426 80 00		Con.term.board unit	1
44	82 80 82		O-ring 104.5X3 FPM	1
45	81 41 04		Hexagon head screw M8X20-A2-70	3
46	82 35 16		Plain washer 8-A2-170	3
48	83 42 28		End sleeve 2.5 MM2; L=7 MM	12
48	83 42 28		End sleeve 2.5 MM2; L=7 MM	6
48	83 42 28		End sleeve 2.5 MM2; L=7 MM	7
48	83 42 29		End sleeve 4 MM2; L=10 MM	1
48	83 42 30		End sleeve 6 MM2; L=10 MM	6

Pos. No	Part. No	Type	Denomination	Qty/Version
				290
48	83 42 29		End sleeve 4 MM2; L=10 MM	3
48	83 42 30		End sleeve 6 MM2; L=10 MM	1
48	83 42 28		End sleeve 2.5 MM2; L=7 MM	4
48	83 42 38		End sleeve 1.5 MM2; L=7 MM	2
49	83 42 36		End sleeve 0.75 MM2; L=6 MM	2
49	83 42 35		End sleeve 10 MM2; L=12 MM	3
51	83 44 23		Closed-end splice 4.0-9.0 (AWG 8) L=28	1
51	83 44 24		Closed-end splice 3-6(AWG 12-10) L=18	1
52	94 05 13		Insulating hose D=14 MM	*
53	81 41 04		Hexagon head screw M8X20-A2-70	2
56	426 78 00		Earthing plate	2
57	438 09 00		Protective disc	1
61	83 33 15		Ball bearing 6306-2Z C3-CLEARANCE	1
69	428 10 09	(Ex)	Stator housing	1
72	82 80 85		O-ring 159.3X5.7 FPM	1
73	308 92 06	(Ex)	Shaft unit 21-10-4A	1
73	308 92 05	(Ex)	Shaft unit 21-12-4A	1
73	309 54 03	(Ex)	Shaft unit 21-11-2A	1
79	426 63 12		Stator 21-10-4a 60 Hz 4-poles 440V-460V YSER 220V-230V Y// P2=6,30kW/8,50hp	1
79	426 63 28		Stator 21-10-4a 50 Hz 4-poles 190V-200V D P2=5,30kW	1
79	426 63 02		Stator 21-10-4a 50 Hz 4-poles 400V Y 230V D P2=5,30kW	1
79	426 63 34		Stator 21-10-4a 50 Hz 4-poles 380V Y 220V D P2=5,30kW	1
79	426 63 38		Stator 21-10-4a 60 Hz 4-poles 440V-460V Y 260V D P2=6,30kW/8,50hp 50 Hz 4-poles 380V D 660V Y P2=5,30kW	1
79	426 63 40		Stator 21-10-4a 50 Hz 4-poles 400V D P2=5,30kW 60 Hz 4-poles 400V D P2=6,30kW/ 8,50hp	1
79	426 63 44		Stator 21-10-4a 50 Hz 4-poles 400V-440V D P2=5,30kW 60 Hz 4-poles 480V D P2=6,30kW/ 8,50hp	1
79	426 63 01		Stator 21-10-4a 50 Hz 4-poles 690V Y 400V D P2=5,30kW	1
79	426 63 52		Stator 21-10-4a 50 Hz 4-poles 500V-550V D P2=5,30kW 60 Hz 4-poles 575V-600V D P2=6,30kW/8,50hp	1
79	309 44 12		Stator 21-12-4a 60 Hz 4-poles 440V-460V YSER 220V-230V Y// P2=8,20kW/11hp	1

Pos. No	Part. No	Type	Denomination	Qty/Version
				290
79	309 44 28		Stator 21-12-4a 50 Hz 4-poles 190V-200V D P2=6,70kW Stator 3-phase 60 Hz 4-poles 200V-220V D 380V Y P2=8,20kW/ 11hp	1
79	309 44 30		Stator 21-12-4a 60 Hz 4-poles 380V D P2=8,20kW/ 11hp	1
79	309 44 32		Stator 21-12-4a 50 Hz 4-poles 346V-350V Y 200V-208V D P2=6,70kW Stator 3-phase 60 Hz 4-poles 230V-240V D 400V Y P2=8,20kW/ 11hp	1
79	309 44 34		Stator 21-12-4a 50 Hz 4-poles 380V-400V Y 220V-230V D P2=6,70kW 60 Hz 4-poles 440V-460V Y 260V D P2=8,20kW/11hp	1
79	309 44 38		Stator 21-12-4a 50 Hz 4-poles 380V-400V D 660V-690V Y P2=6,70kW 60 Hz 4-poles 440V-460V D P2=8,20kW/11hp	1
79	309 44 40		Stator 21-12-4a 50 Hz 4-poles 400V D P2=6,70kW 60 Hz 4-poles 400V D P2=8,20kW/ 11hp	1
79	309 44 44		Stator 21-12-4a 50 Hz 4-poles 400V-440V D P2=6,70kW 60 Hz 4-poles 480V D P2=8,20kW/ 11hp	1
79	309 44 52		Stator 21-12-4a 50 Hz 4-poles 500V-550V D P2=6,70kW Max ambient temp=40 DC 60 Hz 4-poles 575V-600V D P2=8,20kW/11hp	1
79	309 44 58		Stator 21-12-4a 50 Hz 4-poles 660V-690V D P2=6,70kW	1
79	309 49 12		Stator 21-11-2a 60 Hz 2-poles 440V-460V YSER 220V-230V Y// P2=8,90kW/12hp	1
79	309 49 28		Stator 21-11-2a 50 Hz 2-poles 190V-200V D P2=8kW 60 Hz 2-poles 200V-220V D 380V Y P2=8,90kW/12hp	1
79	309 49 30		Stator 21-11-2a 60 Hz 2-poles 380V D P2=8,90kW/ 12hp	1
79	309 49 34		Stator 21-11-2a 50 Hz 2-poles 380V Y 220V D P2=8kW 60 Hz 2-poles 440V-460V Y 260V D P2=8,90kW/12hp	1
79	309 49 38		Stator 21-11-2a 50 Hz 2-poles 380V D 660V Y P2=8kW 60 Hz 2-poles 440V-460V D P2=8,90kW/12hp	1

Pos. No	Part. No	Type	Denomination	Qty/Version
				290
79	309 49 40		Stator 21-11-2a 50 Hz 2-poles 400V D P2=8kW 60 Hz 2-poles 400V D P2=8,90kW/ 12hp	1
79	309 49 44		Stator 21-11-2a 50 Hz 2-poles 400V-440V D P2=8kW 60 Hz 2-poles 480V D P2=8,90kW/ 12hp	1
79	309 49 52		Stator 21-11-2a 50 Hz 2-poles 500V-550V D P2=8kW 60 Hz 2-poles 575V-600V D P2=8,90kW/12hp	1
79	309 49 01		Stator 21-11-2a 50 Hz 2-poles 400V Y 230V D P2=8kW	1
79	309 49 02		Stator 21-11-2a 50 Hz 2-poles 690V Y 400V D P2=8kW	1
82	428 17 00		Outer casing	1
83	82 80 87		O-ring 249.3X5.7 FPM	1
84	82 81 06		O-ring 259.3X5.7 FPM	1
86	382 88 00		Plug	2
89	439 73 01		Pipe	1
96	428 18 00		Sleeve	2
96	429 29 01		Plug	2
100	82 72 95		O-ring 19.2X3 FPM	4
101	504 78 10		Cable unit (FLS)	1
103	518 89 02		Leakage sensor (FLS)	1
105	434 51 00	(Ex)	Bearing housing	1
107	82 59 06		Retaining ring SGA 40	1
108	82 44 15		Supporting washer 40X50X2.5	1
109	83 37 17		Ball bearing	1
110	434 52 00		Bearing cover	1
111	82 81 55		O-ring 89.1X5.7 FPM	1
112	82 00 34		Hex.socket hd screw M8X25-A2-70	6
114	720 63 00		Mechanical seal WCCR/WCCR	1
120	428 22 05		Inspection screw A4	2
122	82 72 95		O-ring 19.2X3 FPM	2
123	429 25 01		Pipe	1
129	428 16 00		Oil housing	1
130	82 80 86		O-ring 239.3X5.7 FPM	1
131	82 80 87		O-ring 249.3X5.7 FPM	1
133	83 03 47		Hex.socket hd screw M12X35-A4-70	4
141	720 63 06		Mechanical seal	1
145	80 96 80		Stud M12X40-A4-70	6
147	82 23 35		Hexagon nut M12-A4-70	6
148	80 78 72		Parallel key	1
158	429 04 00		Impeller 430 MT 50Hz	1

Pos. No	Part. No	Type	Denomination	Qty/Version	
				290	
158	429 05 00		Impeller	432 MT 50Hz 432 MT 60Hz	1
158	429 06 00		Impeller	250 HT 50Hz	1
158	429 06 04		Impeller	252HT 50Hz	1
158	436 83 03		Impeller	461HT 50Hz 461 HT 60Hz	1
158	436 83 04		Impeller	462 HT 50Hz 462 HT 60Hz	1
158	436 83 00		Impeller	467HT 50Hz 467HT 60Hz	1
158	439 22 00		Impeller	475 MT 50Hz	1
158	439 22 09		Impeller	477 MT 60Hz	1
158	439 22 11		Impeller	478MT 50Hz 478 MT 60Hz	1
158	439 22 13		Impeller	479 MT 50Hz 479 MT 60Hz	1
158	439 22 20		Impeller	287 HT 50Hz 287 HT 60Hz	1
162	338 13 06		Plain washer		1
169	84 42 54		Hex.socket hd screw MC6S 12X40-2343		1
178	309 58 01		Supporting washer	D-impeller MT	1
178	457 66 01		Inlet cone		1
178	457 66 00		Inlet cone		1
179	82 75 22		O-ring 279.3X5.7 FPM		1
180	81 94 07		Slotted head screw M8X25-A4-70		4
183	457 67 01		Supporting washer		1
184	309 34 02		Wear ring	HT C	1
184	309 29 02		Wear ring	C-impeller MT	1
188	309 68 01		Suction cover		1
191	436 84 00		Suction cover		1
193	81 93 91		Slotted head screw M6X16-A4-70		3
197	81 49 05		Hexagon head screw M12X25-A4-70		4
200	429 03 00		Pump housing	MT C D DN 100 Installation: P Undrilled	1
200	429 03 01		Pump housing	MT C D DN 100 Drilled acc. to: EN 1092-2 tab. 9 Installation: P T Z	1
200	429 03 02		Pump housing	MT C D DN 100 Drilled acc. to: Standard of the year of 1882 Installation: P S Undrilled	1
200	429 03 05		Pump housing	MT Pressure characteristics variant: HT1 C D DN 100 Installation: P T Undrilled	1
200	429 02 00		Pump housing	HT D DN 80 Installation: P Undrilled HT C DN 80 Installation: P T Undrilled	1

Pos. No	Part. No	Type	Denomination	Qty/Version
				290
200	429 02 01		Pump housing HT D DN 80 Drilled acc. to: Standard of the year of 1882 Installation: P S HT C DN 80 Drilled acc. to: Standard of the year of 1882 Installation: P S	1
200	429 02 07		Pump housing HT C DN 80 Drilled acc. to: EN 1092-2 tab. 9 Installation: P HT D DN 80 Drilled acc. to: EN 1092-2 tab. 9 Installation: P	1
200	436 82 00		Pump housing HT C DN 100 Installation: P T Undrilled	1
200	436 82 02		Pump housing HT C DN 100 Drilled acc. to: Standard of the year of 1882 Installation: P S	1
200	436 82 05		Pump housing HT C DN 100 Drilled acc. to: ANSI B16.1-89; tab.5 Installation: P T	1
209	429 07 00		Sliding bracket	1
210	83 04 53		Hex.socket hd screw M12X45-A4-80	4
211	429 13 00		Discharge connection HT Hydraulic: C D Drilled according to : Standard of the year of 1882 DN 100 MT Hydraulic: C D DN 100 Undrilled	1
211	429 12 00		Discharge connection HT Hydraulic: C D Drilled according to : Standard of the year of 1882	1
212	81 49 58		Hexagon head screw M20X60-A4-70 HT MT	4
212	81 49 36		Hexagon head screw M16X65-A4-70 HT	4
213	82 35 78		Plain washer 16-A4-A-170 MT HT	4
213	82 35 79		Plain washer 20-A4-A-170 HT MT	4
215	82 23 38		Hexagon nut M20-A4-70 HT MT	4
215	82 23 37		Hexagon nut M16-A4-70 HT	4
216	82 81 13		O-ring 109,1X5,7 FPM	1
217	310 12 02		Support complete	2
218	84 34 03		Hexagon head screw M16X40-A2-70 HT MT HT MT	4
218	81 41 56		Hexagon head screw M12X35-A2-70 HT	4
218	81 41 81		Hexagon head screw M16X40-A4-70 MT	4
219	82 35 23		Plain washer 16-A2-A-170 HT MT HT MT	4
219	82 35 20		Plain washer 12-A2-170 HT	4
219	82 35 77		Plain washer 12-A4-170HV HT Hydraulic:	4
220	431 75 00		Suction connection HT MT DN 150 Undrilled	1
220,1	84 34 03		Hexagon head screw M16X40-A2-70	4
220,2	429 15 00		Cleaning door	1
220,3	82 80 92		O-ring 144.5X3 FPM	1

Pos. No	Part. No	Type	Denomination	Qty/Version
				290
220	431 75 06		Suction connection HT MT Drilled according to : EN 1092-2 tab. 9 DN 150	1
220,1	84 34 03		Hexagon head screw M16X40-A2-70	4
220,2	429 15 00		Cleaning door	1
220,3	82 80 92		O-ring 144.5X3 FPM	1
220	431 74 00		Suction connection HT DN 80 Undrilled	1
220,1	81 41 55		Hexagon head screw M12X30-A2-70	4
220,2	429 14 00		Cleaning door	1
220,3	82 75 14		O-ring 94.5X3.0 FPM	1
220	431 74 05		Suction connection HT Drilled according to : ANSI B16.1-89; tab.5 DN 100 Undrilled	1
220,1	81 41 55		Hexagon head screw M12X30-A2-70	4
220,2	429 14 00		Cleaning door	1
220,3	82 75 14		O-ring 94.5X3.0 FPM	1
221	82 81 02		O-ring 164.3X5.7 FPM HT MT	1
221	82 72 90		O-ring 124.3X5.7 FPM HT	1
229	667 40 04		Sticker	2
264	82 42 71		Plain washer (30)-32 MM	4
264	82 42 72		Plain washer (32)-34 MM	4
265	84 19 40		Seal sleeve (14)-17 FPM	2
265	84 19 41		Seal sleeve	2
265	84 19 42		Seal sleeve (20)-23 FPM	2
265	84 19 43		Seal sleeve (23)-26 FPM	2
265	84 19 44		Seal sleeve (26)-29 MM	2
265	84 19 45		Seal sleeve (29)-32 MM	2
266	597 98 02		Sleeve	1
313	82 80 84		O-ring 74.2X5.7 FPM	1
314	83 02 95		Hex.socket hd screw M8X12-A4-70	2
901	90 17 52		Oil ISO VG 32	2
902	90 20 54		Grease	*
912	82 72 95		O-ring 19.2X3 FPM	4



ООО «Бауманс Груп» - официальный партнер фирмы Flygt в России.

Тел: +7 495 121 49 50

Эл. почта: info@baumgroup.ru

Сайт: www.baumgroup.ru